

Clarksville-Montgomery County School System  
HEALTH SERVICES  
EPINEPHRINE MEDICATION TRAINING FORM

**\*\*\*CALL 911 if EPI-PEN/TWIN-JECT is administered\*\*\* Ask office personnel to contact parent/guardian.**

**Procedure:**

1. For EPI-PEN single dose injection:
  - a. Pull off the gray safety cap
  - b. Place black tip of EPI-PEN to the lateral (outer) thigh at a right angle to the leg. EPI-PEN should only be injected into the outer thigh.
  - c. Press EPI-PEN hard into the thigh until the auto-injector mechanism functions (listen for the click), and hold in place for 10 seconds. Then remove EPI-PEN and discard in appropriate biohazard container. Massage the injection site for 10 seconds.

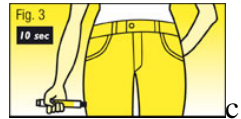
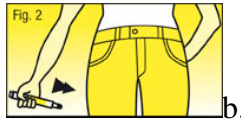
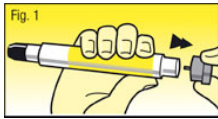

2. For TWIN-JECT auto-injector:
  - a. Pull off the green safety caps, **keep fingers away from red tip**

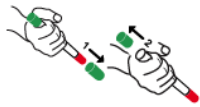

- b. Place red tip of TWIN-JECT to the lateral (outer) thigh at a right angle to the leg. TWIN-JECT should only be injected into the outer thigh. Press TWIN-JECT hard into the thigh until the auto-injector mechanism functions (listen for the click), and hold in place for 10 seconds. Then remove the needle and massage the injection site for 10 seconds.



- c. If symptoms persist after 10 minutes, and a second dose is needed, unscrew and remove the red tip. Be careful to avoid the exposed needle.



- d. Pull the blue tip syringe from the outer plastic covering; do not touch the exposed needle.

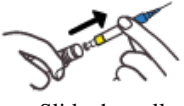

- e. Slide the yellow collar of the plunger; be careful not to pull up on the plunger while removing the collar.

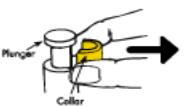

- f. Put the needle into outer thigh, and push the plunger all the way in, until it will not go any further.



3. Continue to monitor the student for absent breathing/pulse until arrival of EMS
  - a. Begin CPR for absent breathing/pulse
  - b. Offer reassurance to the student, as appropriate

Name of Trainee (PRINT): \_\_\_\_\_ Date: \_\_\_\_\_

Signature of Trainee: \_\_\_\_\_ Position: \_\_\_\_\_

Signature of Trainer: \_\_\_\_\_ Date: \_\_\_\_\_